



STAINLESS STEEL NUTS & BOLTS



EQM Hygiene hardware is designed in stainless steel and combines high surface quality and sealed bolting areas. The sealed mounting surface enables fastening without dead spaces and ensures reliable contact pressure after installation.

EQM Hygiene nuts and bolts are produced in stainless steel (SS316), the hygienic seals are in blue foodgrade silicon and included in the delivery.

DH100-M Series

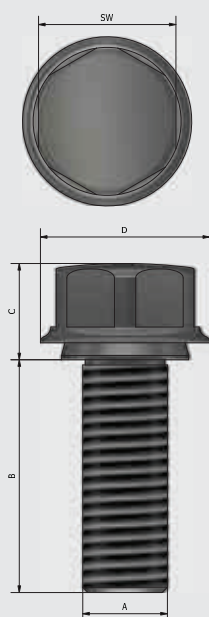

DH100-F Series

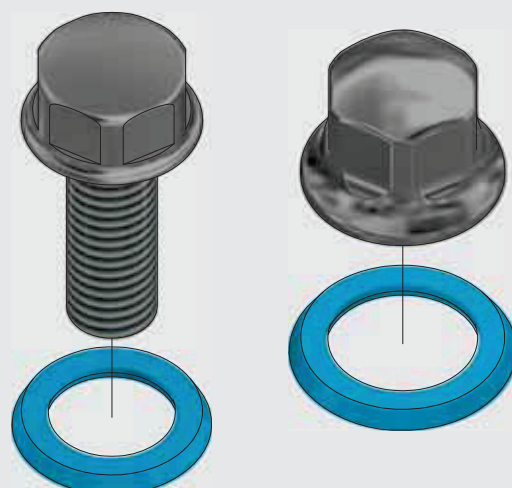
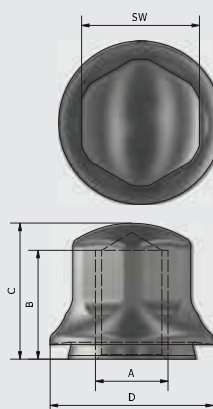



DH100-M Series

Part name	A	B	C	D	SW
DH100 M8x12-9,1-16-M	M8	12	9,1	16	13
DH100 M8x16-9,1-16-M	M8	16	9,1	16	13
DH100 M8x20-9,1-16-M	M8	20	9,1	16	13
DH100 M8x22-9,1-16-M	M8	22	9,1	16	13
DH100 M8x25-9,1-16-M	M8	25	9,1	16	13
DH100 M8x30-9,1-16-M	M8	30	9,1	16	13
DH100 M8x35-9,1-16-M	M8	35	9,1	16	13

Part name	A	B	C	D	SW
DH100 M12x20-11,1-23-M	M12	20	11,1	23	19
DH100 M12x25-11,1-23-M	M12	25	11,1	23	19
DH100 M12x30-11,1-23-M	M12	30	11,1	23	19
DH100 M12x35-11,1-23-M	M12	35	11,1	23	19
DH100 M12x40-11,1-23-M	M12	40	11,1	23	19
DH100 M12x45-11,1-23-M	M12	45	11,1	23	19

Part name	A	B	C	D	SW
DH100 M16x20-13,1-28-M	M16	20	13,1	28	24
DH100 M16x25-13,1-28-M	M16	25	13,1	28	24
DH100 M16x30-13,1-28-M	M16	30	13,1	28	24
DH100 M16x35-13,1-28-M	M16	35	13,1	28	24
DH100 M16x40-13,1-28-M	M16	40	13,1	28	24
DH100 M16x45-13,1-28-M	M16	45	13,1	28	24

Part name	A	B	C	D	SW
DH100 M10x16-10,1-21-M	M10	16	10,1	21	17
DH100 M10x20-10,1-21-M	M10	20	10,1	21	17
DH100 M10x25-10,1-21-M	M10	25	10,1	21	17
DH100 M10x30-10,1-21-M	M10	30	10,1	21	17
DH100 M10x35-10,1-21-M	M10	35	10,1	21	17
DH100 M10x40-10,1-21-M	M10	40	10,1	21	17
DH100 M10x45-10,1-21-M	M10	45	10,1	21	17

Part name	A	B	C	D	SW
DH100 M14x25-12,1-25-M	M14	25	12,1	25	22
DH100 M14x30-12,1-25-M	M14	30	12,1	25	22
DH100 M14x35-12,1-25-M	M14	35	12,1	25	22
DH100 M14x40-12,1-25-M	M14	40	12,1	25	22
DH100 M14x45-12,1-25-M	M14	45	12,1	25	22

Part name	A	B	C	D	SW
DH100 M18x25-16,1-31-M	M18	25	16,1	31	27
DH100 M18x30-16,1-31-M	M18	30	16,1	31	27
DH100 M18x35-16,1-31-M	M18	35	16,1	31	27
DH100 M18x40-16,1-31-M	M18	40	16,1	31	27
DH100 M18x50-16,1-31-M	M18	50	16,1	31	27

DH100-F Series

Part name	A	B	C	D	SW
DH100 M8-12-15-18-F	M8	12	15	18	13
DH100 M10-12-17-21-F	M10	12	17	21	17
DH100 M12-15-19-23-F	M12	15	19	23	19
DH100 M14-18-22-26-F	M14	18	22	26	22
DH100 M16-19-25-28-F	M16	19	25	28	24
DH100 M18-25-30-32-F	M18	25	30	32	27

• All sizes in **mm**