

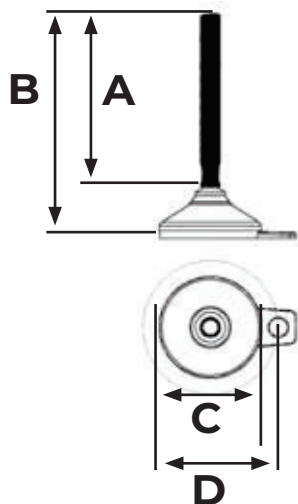

HYGIENIC LEVELLING FEET



HX FIXING

HX FIXING Fully Threaded Levelling Foot FDA Approved, Anti-Slip Rubber.					Max Static Load
	A	B	C	D	(N)
M16 M20 *	70	109	65	46.9	32,000/49,000
	97	136	80	53.2	32,000/49,000
	139	178	105	70	29,000/49,000
	172	211	125	80	20,000/48,000

* In Stock

All sizes in mm

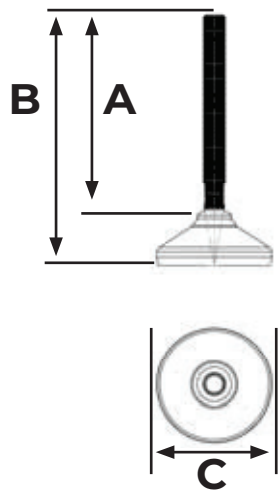

HX

HX Fully Threaded Levelling Foot FDA Approved, Anti-Slip Rubber.				Max Static Load
	A	B	C	(N)
M12 M16 *	70	109	65	32,000/49,000
	97	136	80	32,000/49,000
	139	178	105	29,000/49,000
	172	211	125	20,000/48,000
	223	262	150	12,500/30,000

* In Stock

All sizes in mm

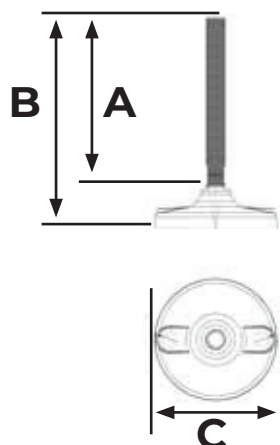

HPA AS FIXING

HPA AS FIXING Fully Threaded Plastic Levelling Foot. Anti-Slip Pad.				Max Static Load
	A	B	C	(N)
M16	140	171	80	29,000
M20	140	174	100	49,000

* In Stock

All sizes in mm

Large range of sizes available on request.