



EQMINDUSTRIAL

Optimising Performance

Conveyor Systems Catalogue

The background of the entire page is a photograph of an industrial conveyor system. In the foreground, several glass bottles are moving along a metal conveyor belt. In the background, there are large, curved metal structures, possibly part of a sorting or packaging machine, with blue components. The image is overlaid with a green gradient that covers most of the page.

MOVE

WHY EQM?

At EQM, we focus on optimising your equipment's performance as your complete solutions partner.

- Wide and innovative product range
- Components or fully assembled systems
- Introduction of the latest technology
- Turnkey, easy-to-install solutions
- Extensive stock on hand
- Fast, flexible delivery
- Full parts and service support

OUR VISION

Where every engineer in NZ making and maintaining a conveyor or equipment buys all the design ideas, drives, bearings and components to complete the task at hand or planned.

OUR MISSION

At EQM Industrial, our mission is to constantly search for how we can do things better, using our knowledge and expertise to create better solutions, implement improved systems and processes, ensure better delivery, and stay ahead in the industry to better serve our clients.

35 YEARS OF HISTORY

EQM Industrial began in 1990 as Equipment Market, supplying second-hand power transmission, food handling, and packhouse conveying equipment. Back then, everything was mechanical with plenty of moving parts. Anthony Bloxham joined in 1993.

In 1995, Anthony's father David purchased the business, and in 1998, his brother Tim came on board. As technology advanced, so did the product range. By 2006, EQM was importing new gearboxes and motors from Italy to meet rising demand for reliable, high-quality equipment.

The company rebranded in 2010 to EQM Industrial, shifting focus to supplying new equipment. In 2012, conveyor customisation became a key strength, delivering tailored solutions to improve production.

In 2015, the product range was grouped into EQM Drive, EQM Move and EQM Pack. This made it easier for clients to find what they need.

With the 2020 pandemic, hygiene and food safety became a top priority. This led to the launch of EQM Hygiene in 2022, offering washdown motors, gearboxes, bearings and hardware.

In 2024, EQM took another major step by acquiring the conveyor division of Autoline Automation and expanding its offering with new conveyor brands, outlined in this MOVE catalogue.

WE HAVE PRODUCTS ACROSS FOUR AREAS

DRIVE

Where OEM's, Engineers, manufacturers and factories find all kinds of simple and complex power transmission solutions.

MOVE

Our conveyors and componentry help manufacturers and production facilities to reduce cost of production by streamlining processes and driving productivity.

PACK

Fruit and vegetable packing lines and equipment that efficiently transform the harvest into highly presentable, retail-ready, export-quality produce with minimal waste.

HYGIENE

Hygiene delivers stainless-steel industrial products like bearing units, gearboxes, motors and hardware for high-care food processing environments.

CONTENTS

Why EQM? / 35 Years Of History / Our Vision / Our Mission	2
EQM Brands	4
EQM New Website	5

CONVEYOR SYSTEMS

AluPro Belt Conveyors	8-9
Easy Conveyors	10-11
Modu Conveyors	12-15
RollPro Rollers Conveyors	16
Modular Conveyors	17
Stainless Steel Conveyors	18-19
Accumulation Conveyors	20-21
Gripper Conveyors	22-23
90 Degree Belt Conveyors	24
Specialty Conveyors	25

SPECIALIST EQUIPMENT

Bottle Inverter Air Rinser Systems	30-31
Depalletisers	32-33
Auto Adjustable Guide System	34-35
Carton Packing Systems	36-37
Rotary Tables	38-39

CONVEYOR COMPONENTARY

Modular Belts	44
Chain & Belt Sprockets	44
Slatband Chains	45
Curves & Straight Tracks	45
Extruded Profiles	46
Conveyor Components	46
Bearing Supports	47
Leveling Feet	47
Motorised Drive Drums	48-49

EQM BRANDS



AluPro Belt Conveyors offers a modular and compact system built to suit your customised application.



Easy Conveyors is a company with 25 years of experience in the area of conveyor modules and components.



Modu system is a global brand for modular conveyor system. We have one of the widest range of conveyor products in the market, ready to cater your ideal conveyor solution.



Movex design and manufacture high-quality conveyor components for the beverage, packaging, food, logistics, automotive and automation industries.



RollPro Roller Conveyors offers gravity and powered systems, ideal for transporting anything from boxes to pallets.



GuidePro changing bottle guides on conveyors in seconds.



NGI provides hygienic, sustainable solutions for the food industry, backed by 50+ years of innovation and a commitment to raising hygiene standards through collaboration.



EQM Hygiene brand brings together a complete range of stainless-steel industrial products from bearing units, to gearboxes, motors, hardware and more for the very challenging high care food processing industries.

EQM NEW WEBSITE

Always up to date with our latest news and products!

WEB STORE
NOW LIVE!

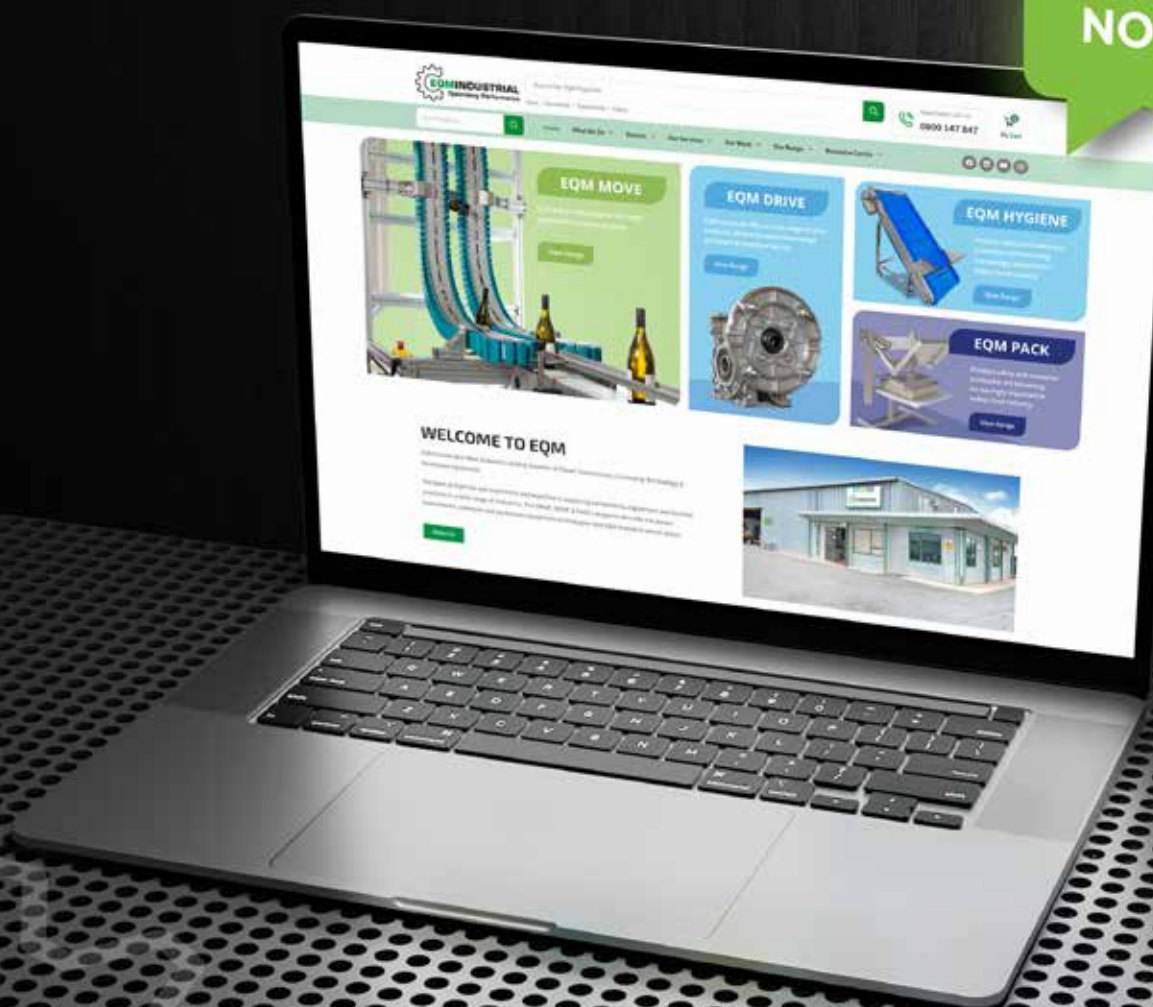

Explore the new EQM website

Browse our full range of solutions, view the digital catalogue, and shop online, all in one place. Stay connected by following us on social media for the latest updates and product releases.

EQM brings innovation and quality to your fingertips, anytime, anywhere.



MOVE CONVEYOR SYSTEMS

AluPro Belt Conveyors	8-9
-----------------------	-----

Easy Conveyors	10-11
----------------	-------

Modu Conveyors	12-15
----------------	-------

RollPro Roller Conveyors	16
--------------------------	----

Modular Conveyors	17
-------------------	----

Stainless Steel Conveyors	18-19
---------------------------	-------

Accumulation Conveyors	20-21
------------------------	-------

Gripper Conveyors	22-23
-------------------	-------

90 Degree Belt Conveyors	24
--------------------------	----

Specialty Conveyors	25
---------------------	----



ALUPRO BELT CONVEYORS

EQM Industrial provides a wide range of belt conveyor systems, including flat and elevating aluminium belt conveyors to suit many different applications.

With AluPro, we build a wide range of customised conveyor systems to suit your industry and work environment. These belt conveyors are constructed from T-slot aluminium extrusion, making them the most compact and modularly designed conveyors in the industry.

These belt conveyors are quick to install and can be easily modified at any time, making the attachment of guide rails, legs, sensors, and brackets simple.



Key Features:

- Safe – Belt runs to the edge to protect operators from potential injury and pinch points.
- Compact – Internal or external drives.
- Versatile – Constructed from aluminium T-slot extrusion, making a flexible and modular yet strong construction style that can be easily modified at any time.
- Reliable – Simple 4-point adjustment for belt tension with drive alignment hidden for more reliable operation.
- Cost-Effective – Due to our compact and modular design, our conveyors are cost-effective solutions.
- Range – Standard widths of 100mm–1200mm and lengths from 250mm–12000mm plus.



AluPro Features

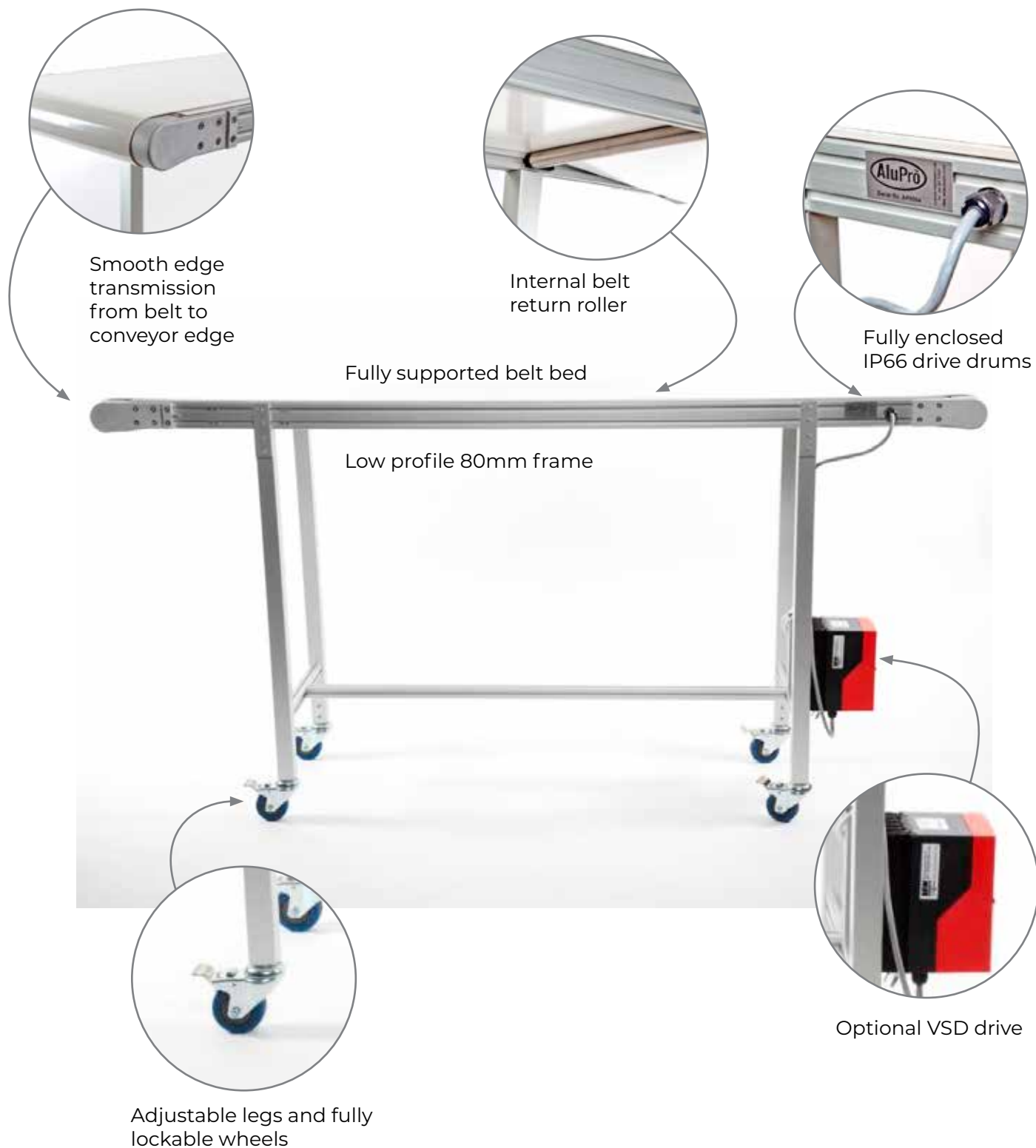

EASY CONVEYORS

Easy Conveyors have five basic types of aluminium conveyors that can be configured and customised to suit your needs. Conveyors can be configured through Easy Conveyor's online configuration, and complete assemblies and full CAD parts are available in major CAD formats. This simplifies the design process and makes Easy Conveyors your simple solution for your conveying needs.

There are multiple conveyor tops to suit all applications:

- EBS Belt Conveyors
- ETS Table Top Conveyors
- EMBS Mat Top Conveyors
- EMCS Mat Top Conveyors
- ERA Roller Conveyors

Key Features:

- Available in stainless steel and aluminium.
- Fully modular construction.
- Economic, space-saving, and flexible system.
- Future-proof; changes and additions are easy to make at any time.
- Simple to install and maintain with the use of simple handheld tools.



ETS Table Top Conveyors

ETS Table Top Conveyors use a close-fitting, multiflex plastic chain for horizontal and vertical transport. Chain widths range from 80–200mm, with lengths up to 30m. Frames are aluminium anodised or stainless steel, and chains are made from white polyacetal, with or without friction top.



EMBS & EMCS Mat Top Conveyors

Flexible, cost-effective systems for transporting large, bulky products.

EMBS: Widths from 255–510mm, with or without friction top. Available in straight, L-, S-, or C-shaped layouts. Supplied as components, modules, or complete systems.

EMCS: Widths from 170–850mm, with or without friction top. Straight belt alternative to PVC/PU systems. Supports horizontal, inclined, and declined layouts (no curves). Chain runs on sprockets—no extra track control needed.

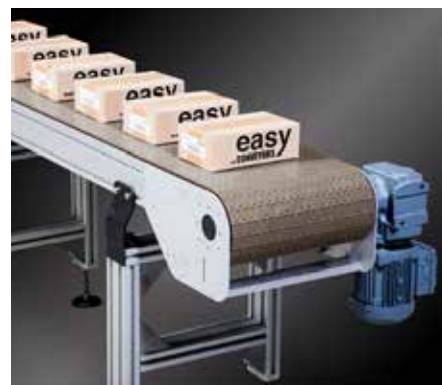

EASY CONVEYORS

EBS Belt Conveyors

The EBS40 is a belt conveyor for light applications up to a weight of 75kg, with widths available from 100 to 600mm.

The EBS80 is a belt conveyor for medium-duty applications up to a weight of 150kg, with widths available from 200 to 1200mm. Their modular design allows flexible use, so you can efficiently adapt, expand, or adjust your current system to different types of machines and equipment designs.

Available in four drive formats and three tail roller sizes.

EBS 40 / 80 – D1

Shaft mounted geardrive on drive drum.



EBS 40 / 80 – II

Transmission drive under head drum.



EBS 40 – M

Central driven reversible shaft mounted drive.



ECDR 40 / 80

Internal Drive Drum Roller.



Small Product Transfer

16mm knife edge entry and exit rollers, for small product transfer.



MODU CONVEYORS

Modu System conveyors are based on a close-fitting flexible chain with the ability to be constructed into many configurations. Products can travel along straights, into curves, or even vertically. The system is quickly assembled from standard modules to accommodate almost any layout. Compact horizontal and vertical bends allow MODU systems to use minimal floor space while ensuring operators have clear access to machinery.

Different chain widths and types provide smooth, gentle handling—minimising product damage and offering safe and reliable product flow. Standard components are manufactured from anodised aluminium, stainless steel, and moulded engineering plastics, providing clean, professional results. In addition, the MODU system is easy to maintain or even modify, minimising costs.

Key Features:

- Minimal dust accumulation allows for easy cleaning
- Low noise and power consumption
- Ability to integrate with other applications and devices such as sensors and diverters
- Easy to install and flexible to match site arrangement layout
- Modular design for easy replacement of component parts, drivers, idlers, and wheel bends

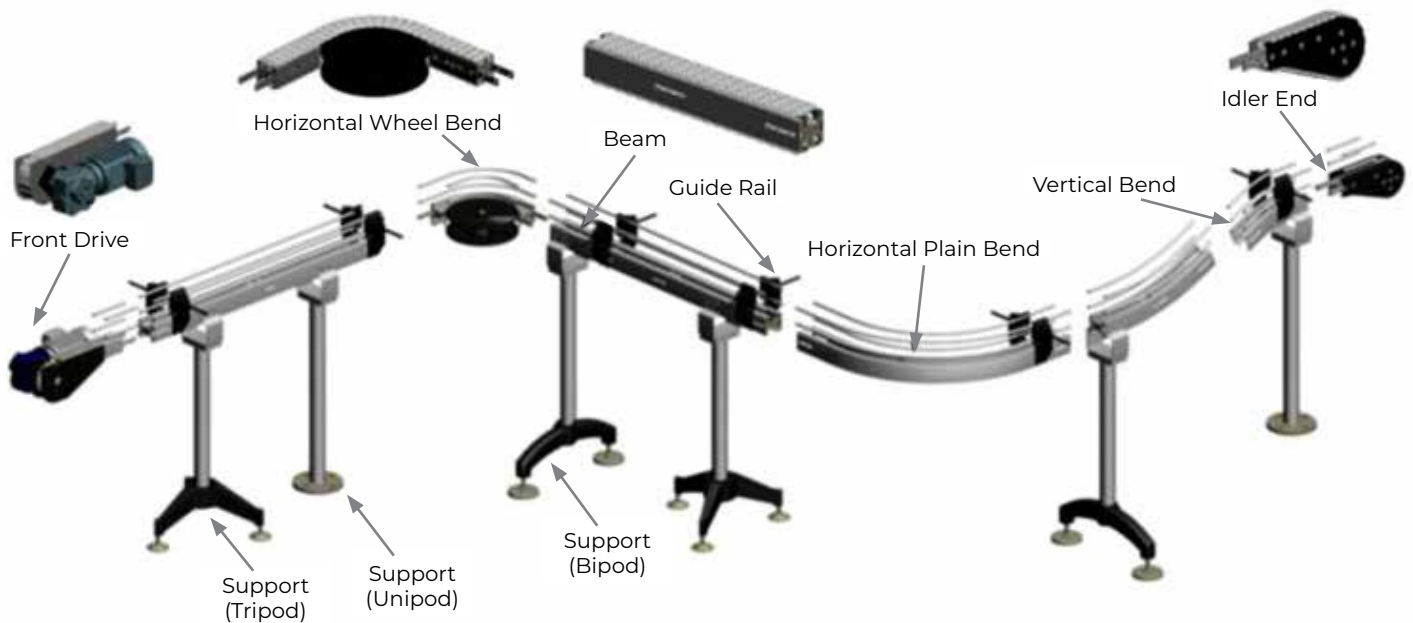

MODU CONVEYORS

MODU Plastic Chain

The MODU System provides diverse plastic chain and belt conveyor systems. All conveyor systems can be effortlessly assembled with standard tools. MODU components are prepared with anodised aluminium and plastic, giving a spotless and aesthetic look. The bends, straights, and supports are made up of pre-assembled pieces, allowing MODU Conveyors to be reconfigured or assembled in minimal time using simple handheld tools.

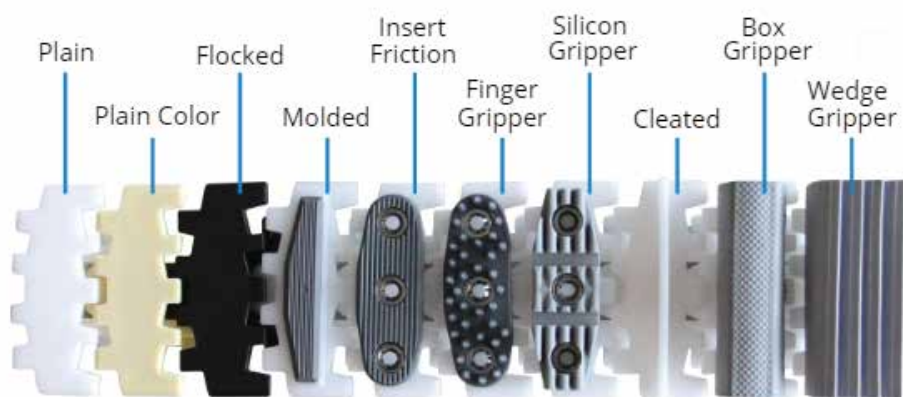

MODU Plastic Belt

The modular plastic belt conveyor system from MODU is a simplified solution for conveying large products. All components of the plastic belt conveyor are standardised for easy engineering, maintenance, and operation. MODU System's plastic belt conveyor is reliable, flexible, safe, and adaptive to any requirements. Plastic belt conveyor systems are designed to integrate with new and existing production equipment.



MODU CONVEYORS

MODU M Series Conveyor

Thermoplastic Chain with Aluminium Frame Conveyor System

MODU System M Series Conveyors are based on an aluminium profiled beam, ranging from 65mm to 225mm in width, guiding a plastic chain. This plastic chain travels on low-friction plastic extruded slide rails to precisely guide the flexible MODU plastic chain.

Conveyor System MM3

83mm width thermoplastic chain with aluminium frame conveyor system.

Also available in stainless steel frame; please refer to DM3.



Conveyor System ML2

140mm width thermoplastic chain with aluminium frame conveyor system.

Also available in stainless steel frame; please refer to DL2.



Conveyor System MX2

220mm width thermoplastic chain with aluminium frame conveyor system.

Also available in stainless steel frame; please refer to DX2.



MODU CONVEYORS

MODU D Series Conveyors

Thermoplastic Chain with Stainless Steel Frame Conveyor System

MODU System D Series Conveyors are based on a stainless steel profiled beam, ranging from 65mm to 225mm in width, guiding a plastic chain. This plastic chain travels on low-friction plastic extruded slide rails to precisely guide the flexible MODU plastic chain.

Conveyor System DM3

83mm width thermoplastic chain with stainless steel frame conveyor system.

Also available in aluminium frame; please refer to MM3.



Conveyor System DL2

140mm width thermoplastic chain with stainless steel frame conveyor system.

Also available in aluminium frame; please refer to ML2.



Conveyor System DX2

220mm width thermoplastic chain with stainless steel frame conveyor system.

Also available in aluminium frame; please refer to MX2.





ROLLPRO ROLLER CONVEYORS

Roller conveyors can be used in many types of material handling situations such as warehouses, assembly line operations, sorting, and packing. Gravity and powered roller conveyors or ball transfers with multi-directional functionality are available.

The gravity roller conveyor is ideal for transporting anything from boxes to pallets. The use of no power makes them a very quiet and cost-effective conveying option. It is a very flexible system, as there is a heavy or light-duty option available, and they can be installed with a small incline depending on your requirements.

Powered roller conveyors are cost-effective, strong, and reliable. A powered conveyor prevents manual lifting and shifting operations by creating a link between existing machinery, reducing double handling of products and labour requirements, and helping to increase efficiency. The rollers are typically driven by bands running from the drive unit and each other.

Key Features:

- Multiple roller spacings
- A range of rollers to suit applications – PVC, galvanised, stainless steel
- Bolt-together construction makes maintenance simple and easy
- Widths up to 1000mm (standard)
- Any length section, maximum 3000mm (standard)
- Infeed/outfeed conveyor solution



MODULAR CONVEYORS

Modular conveyors are ideal for both industrial and washdown environments, commonly used for transporting raw food and other packaged products.

We offer a wide range of plastic modular conveyors designed to meet the handling and conveying needs across various industries.

Specifications:

Conveyor Types: Straight, Bend, Incline, Decline

Speed: Variable speed (5m/min to 60m/min) with VFD control

Belt Material: Acetal (POM), Polypropylene, or PFX

Frame Structure:

- Aluminium
- Mild Steel with powder coating or painting
- Stainless Steel 304

Drive Type: Positively driven modular belts

Applications:

- Direct food contact
- Hygienic environments
- Food packaging lines



Food Production Conveyor.



Outfeed Conveyor for a Vertical Form Fill and Seal (VFFS) Machine.

STAINLESS STEEL CONVEYORS

Stainless steel conveyors are widely used in applications for food manufacturing and in the pharmaceutical industries where cleanliness and hygiene are imperative. Our conveyors' modular design allows for trouble-free line configurations, site installation, and maintenance, making them cost-effective and simple to use.

There are multiple types of stainless steel conveyors to meet many different applications. Types include: Wire Mesh Belt, Modular, Roller, and Fully Washdown homogeneous

Stainless Steel Conveyor Key Features:

- Minimum dust accumulation to allow for easy cleaning
- Low noise and power consumption
- Ability to integrate with other applications and devices such as sensors and diverters
- Easy to install
- Modular design for easy replacement of component parts, drives, idlers, and wheel bends
- Lightweight and heavy-duty design
- IP69K stainless steel or NTT hygiene aluminium shaft-mounted geardrives
- Quick release tail assemblies for easy cleaning





ACCUMULATION CONVEYORS

Accumulation conveyors are designed to momentarily hold and accumulate products before releasing them to the next production phase. The use of an accumulation conveyor helps control product flow when items from multiple lines must be merged into a single line and to even out product line variations.

Accumulation conveyors come in two configurations: accumulation table and alpine conveyor.

The accumulation table has a large storage capacity and accumulates products to generate mass buffering in order to accommodate other processes in a production line. These can also be used to unload jars or bottles onto a filling line.

The alpine accumulating conveyor is compact with a spiral configuration and is used as an accumulation or elevating buffer zone between machines. It can also be used for cooling, drying, or vertically moving products.



Key Features:

- Creates a buffer zone between processes
- Merges multiple line items into a single line
- Controls product line flow and singulates products on the outfeed
- Prevents congestion in conveying lines
- Allows production to continue while changes occur downstream



GRIPPER CONVEYORS

A gripper conveyor consists of two sets of chain conveyors with gripper belting to move products from a lower elevation to an upper elevation, or vice versa, while taking up minimal floor space.

Gripper conveyors are an ideal setup for high-speed production or packaging lines. They hold the product in a firm but gentle manner before releasing it to another conveyor. Gripper conveyors are widely used to elevate and lower food and beverage products. The system consists of two parallel sets of conveyor sections joined on an adjustable mechanism, allowing the unit to accommodate different-sized products.

Key Features:

- Saves floor space and conveyor length
- Maximises space utilisation by creating buffering at ceiling levels
- Easily integrates with other applications such as inverters, air rinsers, blowers, fillers, and packaging lines
- Flexible and lightweight
- Easy to install and accommodate site layouts
- High-capacity vertical transport
- Suitable for empty and full bottles, containers, cartons, pouches, etc.
- Range of gripper belt surfaces to suit hard, soft, or delicate product





90 DEGREE BELT CONVEYORS

Compact 90 degree stainless steel belt Conveyor bend a simple concept of two conical rollers in a small diameter, a very common conveyor used in a large variety of industries.

Allows a conveyor system to turn corners without changing the orientation of the parts.

Specifications

- Belt Width: 200mm, 300mm, 400mm & 600mm
- Inner Radius: 200mm, 250mm, 300mm & 450mm
- Outer Radius: 400mm, 550mm, 700mm, 1150mm
- Working Height: 400–1100mm from floor to top of conveyor, adjustable in height +50mm, fitted with support feet
- Belt Type: PU belt, 2 layers, anti-static, blue in colour, food grade, with plastic wheels and stainless steel bearings
- Standard Transfer: $\varnothing 37\text{mm}$ measured at the centre, $\varnothing 22\text{mm}$ inner radius, and $\varnothing 50\text{mm}$ outer radius
- Shaft-Mounted Geardrive to suit
- Finish: Framework fabricated from stainless steel, glass bead blasted, and fitted with black plastic belt guide



SPECIALITY CONVEYORS

We build a wide range of conveyor systems and can design and build speciality conveyors customised to suit your application and industry. Our speciality conveyors can include elevator, lowerator, 90-degree, and spiral conveyors, plus much more!

Elevator conveyors are used to elevate a product between multiple levels, while a 90-degree conveyor allows a production line to turn corners without changing the orientation of the part.



Injection Moulding
Exit Conveyor



Bottle Caps Elevator.

A faint, light gray watermark is centered on the page. It consists of a large circle with a gear-like shape superimposed on it. The gear has several teeth, and the entire watermark is rendered in a very light gray color, making it subtle against the white background.







MOVE SPECIALIST EQUIPMENT

Bottle Inverter Air Rinser Systems	30-31
------------------------------------	-------

Depalletisers	32-33
---------------	-------

Auto Adjustable Guide System	34-35
------------------------------	-------

Carton Packing Systems	36-37
------------------------	-------

Rotary Tables	38-39
---------------	-------

BOTTLE INVERTER AIR RINSER SYSTEMS

The Bottle Inverter Air Rinser System is designed to use a MODU Gripper Conveyor to invert bottles over an air knife to clean them just prior to filling. The bottles enter in the upright position, do a 360-degree circuit, and exit upright on the opposite side.

Benefits:

- Removes contamination in glass & PET bottles, cans, and jars
- Designed to handle hundreds, even thousands, of bottles per hour continuously
- Two-side gripper conveyors work together to take the bottles through the process
- Easily adjustable mounting to suit various jar sizes
- Compact side channel blower provides filtered air for purge
- Catchment and containment shield to recover potential contaminants
- 450mm-long air knife for continuous purge
- Reliable Italian shaft-mounted geardrives
- Inverter control for variable speed and line efficiency
- Custom framing with safety panels
- HMI controls

Model 7797

- Manual bottle size adjustment
- Aluminium construction
- VSD controlled

Model 7907

- Automated programmable bottle size adjustment
- Variable air rinsing
- Aluminium construction
- HMI controlled

Model 8043

- Automated bottle size adjustment
- Extra filtration and containment recovery
- Completely stainless steel construction
- HMI controlled
- High capacity





Model 7907



Model 8043

DEPALLETISERS

Automate smarter with EQM's bottle and jar depalletiser system designed to streamline your workflow and reduce manual handling.

Built for speed and reliability, the depalletiser conveyor automatically separates stacked items from pallets, feeding them smoothly onto your production line.

It's compatible with a range of pallet types, including Euro pallets, and features intelligent recognition to adapt to different sizes.

By reducing labour input and repetitive lifting, this system helps protect your equipment and staff while keeping your operations moving efficiently. It's a key step in optimising production flow, lowering handling time, and improving overall site safety.

Tailored to suit your setup, EQM depalletiser conveyors can be integrated with air rinsers, packaging lines, and other automation systems, helping you save time, labour, and operational costs.

Model 8262

- Accumulation table for manual pallet unloading – 1.3m long
- Bottle stripper for singulation - 3 lane
- Small footprint layout

Model 7907

- Manual pallet loading
- Automated layer-by-layer transfer
- Accumulation conveyor table – 2.5m long
- Optional bag remover
- Various bottle or container strippers for singulation
- Medium-sized footprint

Model 7329

- Automated pallet loading and discharge
- Automated layer-by-layer transfer
- Accumulation conveyor table – 4.5m long
- Optional automated bag cutting and removal by suction
- Various bottle or container strippers to suit high-speed lines
- Large footprint
- Fully automated HMI controlled system



Model 7907



Model 7907



Model 7329

AUTO ADJUSTABLE GUIDE SYSTEM

Streamline your changeovers with our Auto Adjustable Guide System.

Change bottle guide rails equally in seconds with the push of a button, no manual adjustments required.

The integrated HMI Operator Screen offers intuitive controls for quick, precise line adjustments.

Pre-programmed settings make it easy to switch between specific bottle sizes, reducing downtime and boosting efficiency.





CARTON PACKING SYSTEMS - END OF LINE

Increase your productivity with our vast experience in developing carton packing lines. Take the pressure off your packers and deliver more cartons per hour. Our carton packing systems use combinations of conveyors from all our brands, making them very cost-effective.

These are fabricated and assembled to exact customer requirements.

Remaining flexible due to the kitset designs means configurations can be put together to suit individual customer layout and space requirements.

Key features and benefits from these types of packing systems are:

- Conveyors constructed from Aluminium or Stainless Steel modules
- Clean, functional, ergonomic designs that consider staff well-being by reducing fatigue
- Multiple modular and PVC belting options to suit the product and environment
- Multiple or single packer layout designs – caters for variable production rates
- Central exit conveyors to feed carton closers and tappers, inline coding and labelling, etc.
- Fitted with reliable and efficient STM electric motors and gearboxes
- Additional carton accumulation can be added
- Overhead racks for pre-erected or bundles of cartons

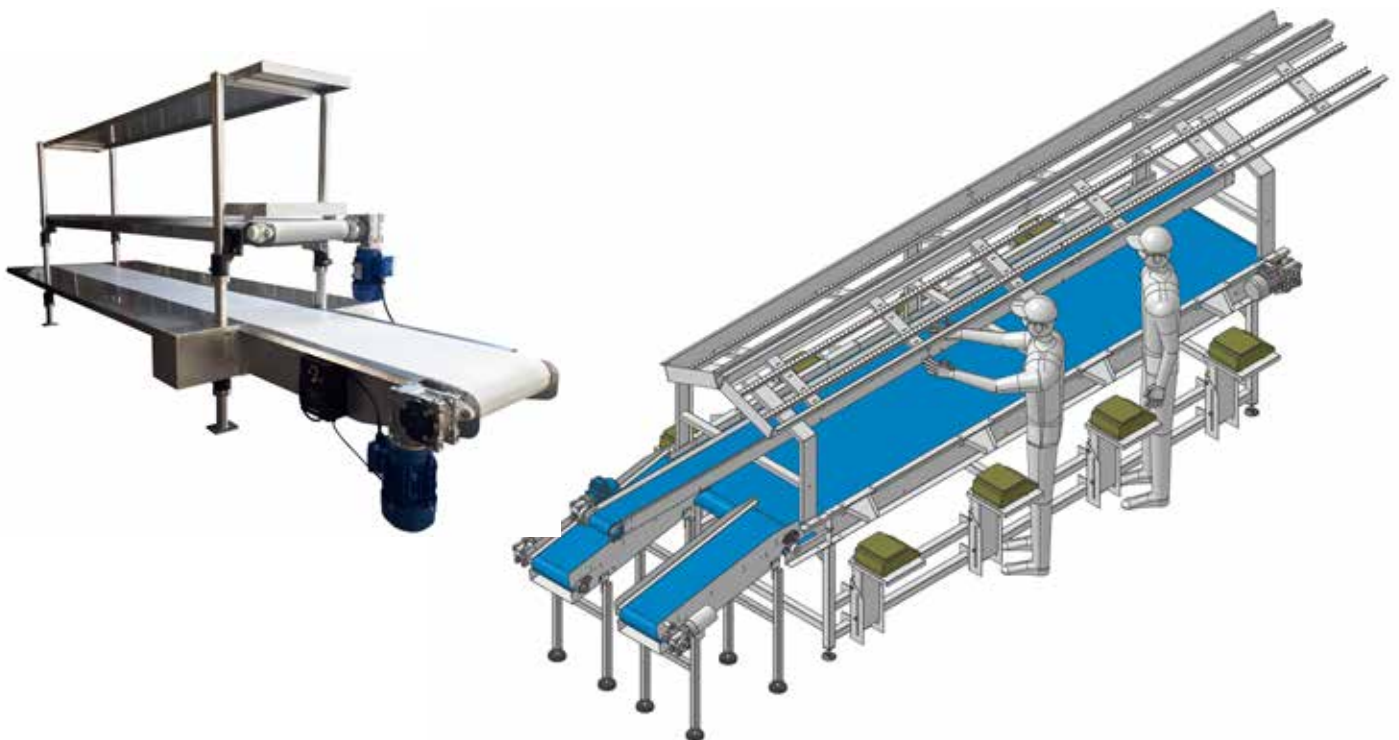



Vegetables



Cherry Line



Blueberries



Tomatoes

ROTARY TABLES

EQM Rotary Tables improve your packing production line.

At EQM, we can customise and modify your Rotary Tables to perfectly match your needs.

Our Rotary Tables are used in a wide range of applications where a product needs to accumulate.

Choose your EQM Rotary Table from three standard types: punnet and package, fruit collection, and bottle and container tables.

Our simple designs make them easy to use. Furthermore, our Rotary Tables are cost-effective, as they are operated by an economical single-phase drive.

Pedestal Rotary Table – Concave Top Version

Do you process bagged products, or packaged products that will sustain damage if they land on each other? Concave rotary tables can bring many efficiencies to your production process. Particularly for those involving form fill and seal machines or flow wrappers.



Rotary Table – Pedestal Version

Perfect for packing areas with tight spots. Small diameter table top can be fitted to these pedestal frames.



Rotary Tables – Custom Built

Purpose Built convex and large diameter rotary table are another specialist product EQM Industrial have developed to improve accumulation and efficiencies in your production line.

**Rotary Table for Punnets/Packages**

Accumulates punnets at the end of a packing line after labelling or quality checking.

Powder Coated Frame Versions In Stock

**Rotary Table for Bottles**

Accumulates bottles anywhere along the bottling line at the beginning, between filling and corking, capping and labelling or at the end.



A faint, light gray watermark of a gear with a circle inside, centered on the page. The gear has eight teeth, and the circle is positioned within the central area of the gear. The watermark is semi-transparent and serves as a background element for the lined paper.

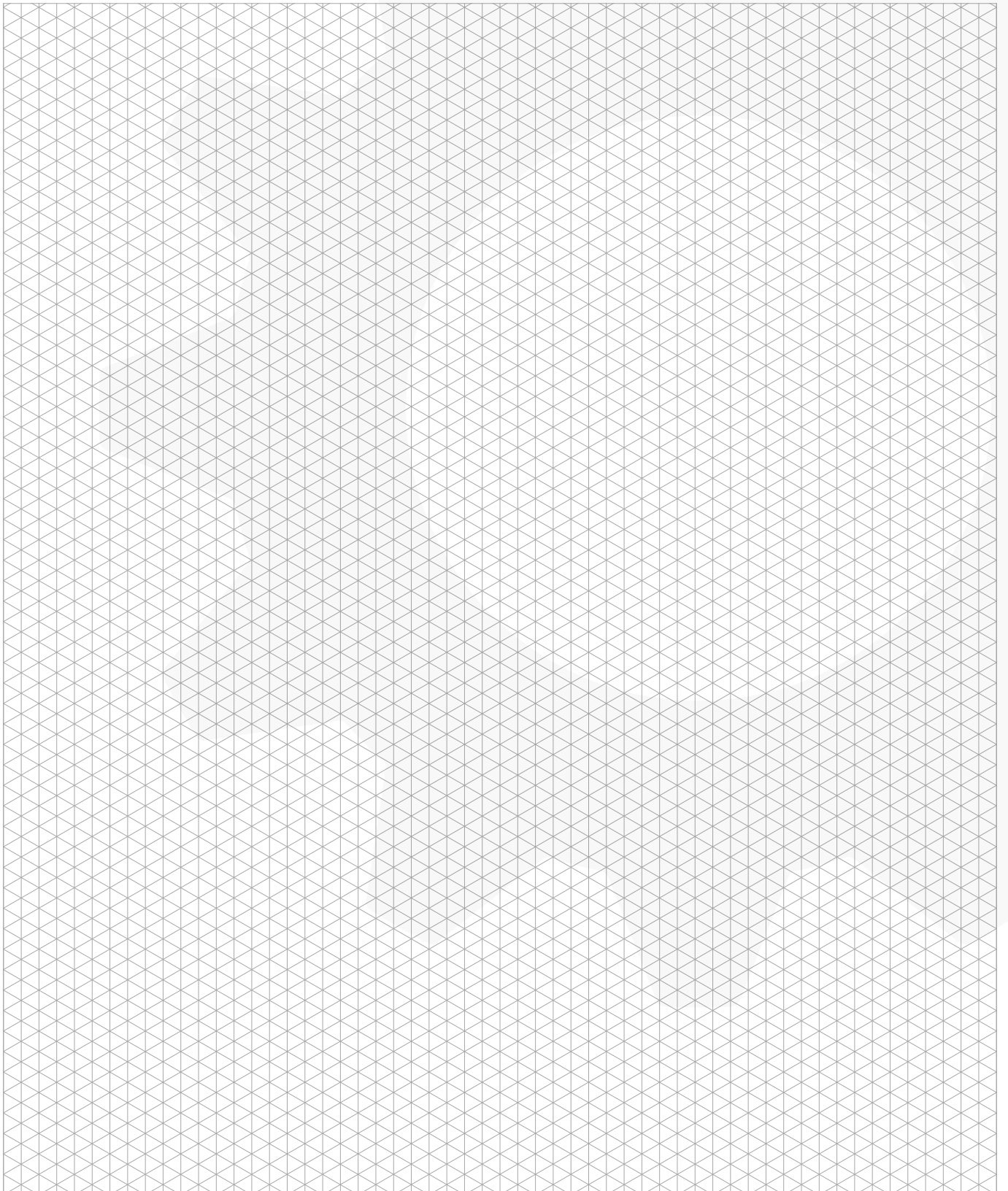

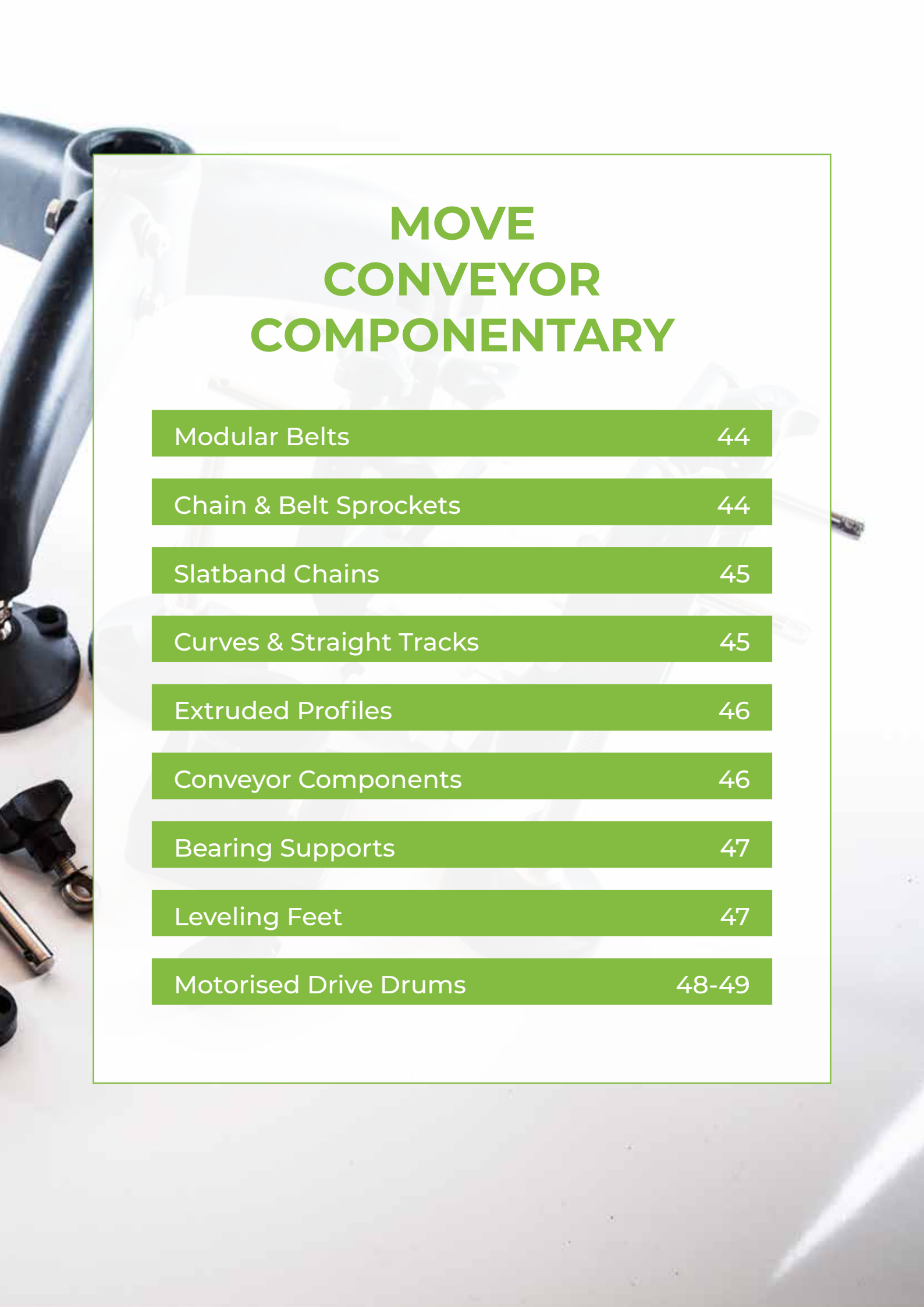

The background of the page features a close-up, slightly blurred photograph of various mechanical components of a conveyor system. On the left, a black rubber conveyor belt is visible, curving upwards. Below it, there are metal rollers, a black plastic pulley, and a metal bracket. The overall scene is brightly lit, with a clean, industrial aesthetic. The title 'MOVE CONVEYOR COMPONENTARY' is centered in a bold, green, sans-serif font.

MOVE CONVEYOR COMPONENTARY

Modular Belts	44
---------------	----

Chain & Belt Sprockets	44
------------------------	----

Slatband Chains	45
-----------------	----

Curves & Straight Tracks	45
--------------------------	----

Extruded Profiles	46
-------------------	----

Conveyor Components	46
---------------------	----

Bearing Supports	47
------------------	----

Leveling Feet	47
---------------	----

Motorised Drive Drums	48-49
-----------------------	-------

MODULAR BELTS

Modular belts are positive drive, low-noise, and long-lasting. Assembled in a bricklay pattern, they can be made to almost any length and width, and a wide range of accessories are available to customise the belt for specific applications or processes.

EQM Industrial has an extensive range available under the Movex brand, manufactured in Italy.

Available in:

Flat Top, Grip Belt, Flush Grid, Roller Top, Raised Rib, Sideflexing

Movex has a wide range available, interchangeable with all leading brands

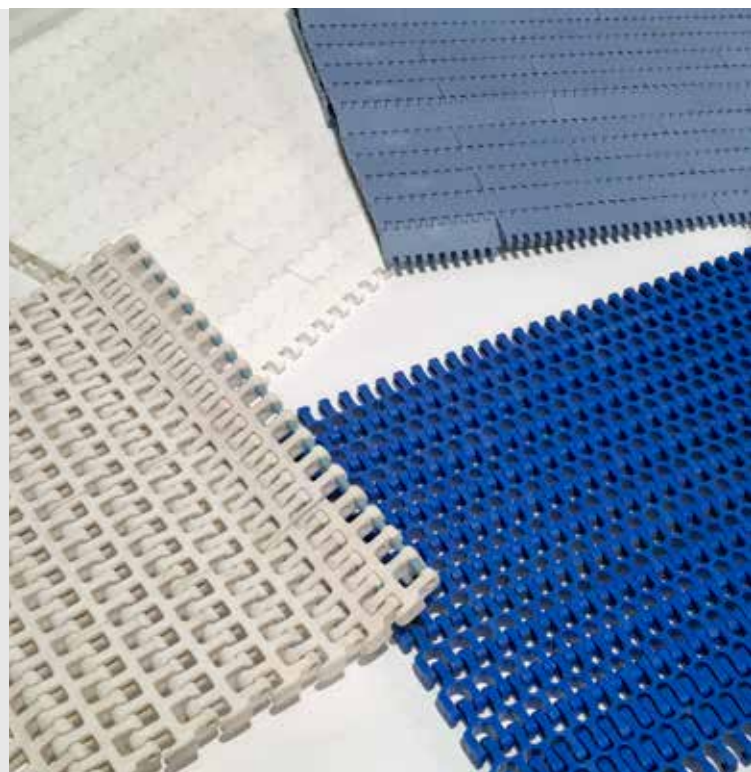

CHAIN & BELT SPROCKETS

Available for straight running and sideflexing chains. Machined and moulded versions. Split drive and idler sprockets. Square bore versions.

Movex has a wide range available, interchangeable with all leading brands



SLATBAND CHAINS

Slat band chains, also known as slat link chains, are continuous conveying surfaces used in assembly lines and packaging. Made from flat slats joined by hinges or chains, they offer a stable, level transport surface. Typically made from stainless steel, hardened plastic, or both, they can be customised for various product sizes and weights.

Available in Mild Steel, Stainless Steel & Plastic

- Straight Running
- Sideflexing
- Tab System
- Magnetic System
- Bevel System

High-performance versions available, Movex chains are compatible with all leading brands.

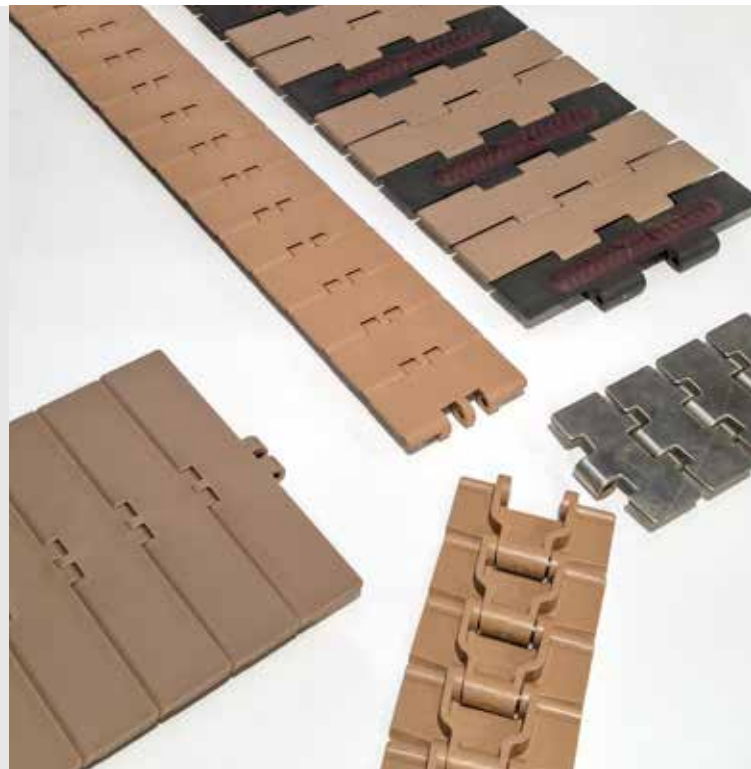

CURVES & STRAIGHT TRACKS

Corner track systems for magnetic, tab & bevel chains

Movex has a wide range available, interchangeable with all leading brands



EXTRUDED PROFILES

Available Profiles:

- L-Profile
- Z-Profile
- J-Profile
- U-Profile
- C-Profile
- Round Profiles
- Bar Cap & Cover
- Side guide rails

Movex has a wide range available, interchangeable with all leading brands.



CONVEYOR COMPONENTS

EQM supplies a full range of components for beverage, bottle, and material handling conveyors, whether you're maintaining existing systems or building new ones.

- Guide Rail Brackets
- Guide Rail Supports
- Star Knobs
- Single & Double Clamps
- T & Cross Clamps
- Bipod & Tripod Support Bases
- Support Heads
- Threaded Inserts
- Roller Guides
- Slide Shoes
- Transfer Modules
- Hinges & Handles

Movex has a wide range available, interchangeable with all leading brands.



BEARING SUPPORTS

EQM offers a wide range of bearing supports and housings for both industrial and hygienic applications, including food processing.

Conveyor Solutions – Movex bearings and polyamide housings

Main features:

- Housing in reinforced polyamide
- Chrome steel or stainless steel ball bearing (pre-lubricated)
- Nickel-plated brass mounting hole spacers
- Nickel plated steel or SS grease nipple with self-forming thread M6
- Polypropylene closed cap with O-ring seal
- Stainless steel washers
- NBR bottom seal



LEVELING FEET

Our range of self-levelling, hygienic feet & castors for food processing and production equipment make your processes easier and more hygienic, giving you better results every time.

HPA Series – Fully Threaded Plastic Levelling Feet

HX Series – Hygienic Fully Threaded Levelling Feet – SS

XH Series – Certified Hygienic Levelling Feet - SS



MOTORISED DRIVE DRUMS

The AX and TM Series Motorised Drum Motors cover the requirements of both light-duty unit handling and heavy-duty belt conveying.



AX Series

AX Series drum motors are a common drive drum suited to many conveying requirements.

Its 84mm and 112mm diameters make it popular for driving PVC conveyor belts in many industries.

Available with all polymer or steel combination planetary gears with oil lubrication these units offer an economic, reliable and versatile conveyor belt drive.



**TM Series**

TM series drum motors are designed for reliability and efficiency in all conveying applications.

The strong gearbox construction and precision gear components mean you can count on your TM series drum motor to keep your plant running.

Available in 82mm, 113mm, 138mm, 165mm, 216mm and 321mm dia.



A faint, light gray watermark is centered on the page. It consists of a large circle with a gear-like shape superimposed on it. The gear has several teeth, and the entire watermark is rendered in a very light gray color, making it subtle against the white background.





EQMINDUSTRIAL

Optimising Performance

518 Omahu Road
Hastings 4120
New Zealand

Freephone: 0800 147 847

Phone: +64 6 878 8475

Email: sales@eqm.co.nz

www.eqm.co.nz